



The Tower, 1 St George Wharf
London SW8

GARTON JONES.COM

The Tower, 1 St George Wharf London, SW8

GARTON JONES.COM

9 Albert
Embankment
London
SE1 7SP

Sales +44 (0) 20 7735 1888
nineelms@gartonjones.com
www.gartonjones.com

£600,000 Leasehold

A Manhattan Suite apartment of 496sq.ft (46sq.m) in the highly sought One St George Wharf (The Tower). This beautifully finished property further benefits from a luxury shower room, a large open plan reception room and full-width floor to ceiling windows. There is a smart fitted kitchen with Miele integrated appliances including a wine cooler and coffee machine, comfort cooling, an Opus comfort control system, porcelain tiled flooring throughout with underfloor heating. Residents will have the use of a 24-hour concierge and health spa with gym, an infinity swimming pool, steam room, sauna, and treatment rooms. There is also a business lounge, cinema screening room and private dining/conference room with re-heat kitchen facility. Vauxhall Station is moments away offering the Victoria Line underground service, overground railways and bus station allowing for very easy access across London.

Leasehold: 976 Years Remaining
Service Charge: Approx. £6,100 per annum
Ground Rent: £500 per annum
Lambeth Council Tax Band F

- EWS1 Compliant
- 496sq.ft (46sq.m)
- Manhattan Suite Apartment
- Open Plan Reception with Smart Integrated Kitchen
- Comfort Cooling
- 24 Hour Concierge
- Residents Gym
- Infinity Swimming Pool Overlooking River Thames
- Sauna & Treatment Rooms
- Moments from Vauxhall Station



EPC certificate available on request.

The Tower

Approximate Gross Internal Area
496 sq ft / 46.1 sq m

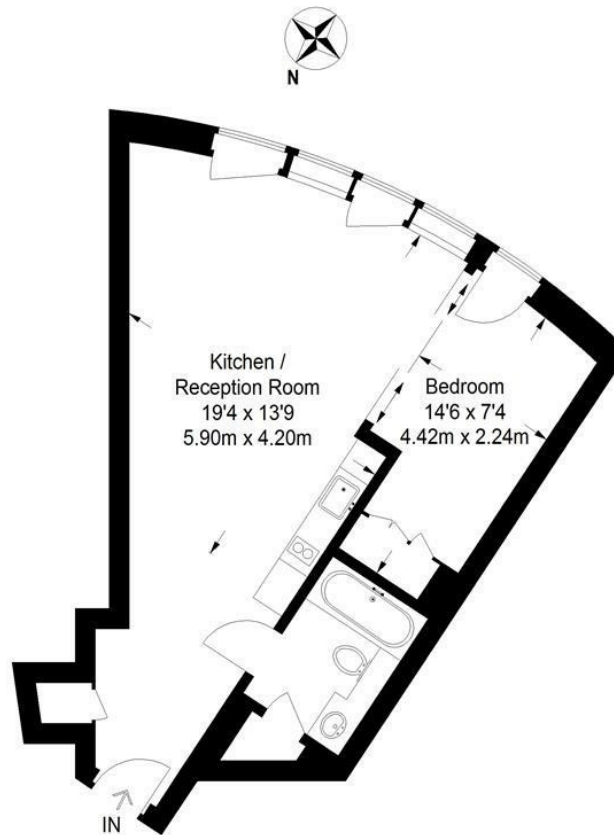

Not to scale, for guidance only and must not be relied upon as a statement of fact.
All measurements and areas are approximate only and have been prepared in
accordance with the current edition of the RICS Code of Measuring Practice.

